



*Royal Kennebecasis
Yacht Club*

Since 1898

TABLE OF CONTENTS

Greeting from the Commodore	3
Contact Information and Administration.....	4
Hours of operation	
Executive and Staff	
Membership Categories	
Membership Rates	
Accounts Receivable Policy	
Club History.....	8
Calendar of Events for 2006	9
Facilities.....	10
Club House	
Club Rental/Catering	
Parking	
Floor Plan	
Marine Services.....	12
Marina	
Berth Assignment Policy	
Dock Layout	
Boat Repair Services	
Spar Shed	
Garbage	
Gas Dock	
Waste Fluids	
Pump Out Station	
Haul Out & Launch	
Storage	
Fee Schedule	
Member Services.....	17
Club Events	
Members' Day	
Buffets	
Volunteers	
Boating Etiquette	18
Sail Past Protocol	
No Wake Zone	
Flag Etiquette	19
Nautical Flag Alphabet	
Sailing and Racing	20
Cruise	
Racing – Monday, Tuesday, Wednesday nights, Special races	
Popular Places to Visit on the Rivers	
River Hazards	
Educational Programs	21
Learn to Sail	
Canadian Power and Sail Squadron courses	
Why Choose the RKYC?.....	22



COMMODORE'S WELCOME

Welcome to the Royal Kennebecasis Yacht Club, the centre of yachting excellence in New Brunswick. Whether you are an existing member, a new member, or one of our visiting guests from around the world, the RKYC provides a warm and friendly atmosphere to enhance your boating experience.

We invite you to join in the Club activities, meet new friends, and utilize our facilities to their fullest. Our Fixture Card lists many of the year's activities and events. The RKYC is completely run by its members through various committees, and their dedication and commitment make the RKYC the successful facility that it is.

The RKYC staff (Club Manager Gary Arthurs, Yard Manager Bob Barnes and Office Assistant Gail Greer) is available to assist you with your needs. If I can be of assistance please feel free to contact me at home 847-7070, on Emerald Lady on "B" Dock, or around the Club (when I'm not out cruising!).

Welcome to the RKYC. It is a pleasure to have you aboard!

Dave Peacock,
Commodore

CONTACT INFORMATION

Mailing Address: Royal Kennebecasis Yacht Club
1042 Millidge Avenue
Saint John N.B.
E2K 2P6

Phone: 1 506 632 0186 (Office)
1 506 652 9430 (Bar Phone)

Fax: 1 506 653 3323

Email: rkyc1@nbnet.nb.ca
Web Site: www.rkyc.nb.ca

Hours of Operation: Monday – Friday thru Friday 0900 - 1500

Staff:

Club Manager	Gary Arthurs
Office Administration	Gail Greer
Yard Manager	Bob Barnes

Administration

EXECUTIVE AND EXECUTIVE COMMITTEES

Commodore	Dave Peacock	847-7070	dpeacock@mci.ca
Vice Commodore	Doug Orford	636-9138	douglas.orford@cibc.ca
Rear Commodore	David Maxwell	632-6911	davidmax@remaxsj.com
Secretary	Bruce Burnham	658-0670	burnham.bruce@irvingforest.com
Treasurer	Stephen Sherlock	757-2777	stephn.sherlock@cibc.ca
Marine Services	Tom Crowley	636-9803	mona.crowley@rogers.com
Strategic Planning	David Crossley	847-2777	dcrosn606@rogers.com
Sailing Committee	Gordon Moulard	635-1566	gord.moulard@fundyeng.com
Marine Services	Ed Saunders		
Member Services	Ken Salmon	657-4217	sjsportsmedclinic@nb.aibn.com
House & Grounds	Graeme Scott		gbscott@nbnet.nb.ca
Fleet Captain	David Eadie	634-8549	eadie.dj@forces.gc.ca
Fleet Surgeon	Dr. John Dorman		
Fleet Chaplain	Rev. Jennifer Uhryniw		
Auditor	Peter Gaulton	634-7393	
Solicitor	Bruce Logan	633-3800	

MEMBERSHIP CATEGORIES

An RKYC membership is required if you use the facilities of the Club more than three times either as a guest or visitor during a one year period.

There are three types of membership at the Royal Kennebecasis Yacht Club – Senior, Associate and Out-port Membership

Senior Membership

A Senior Membership entitles the individual to be a voting member of the RKYC and to have the right to register a vessel at the Club. This membership is required if you will be keeping a boat longer than 19 ft OR greater or equal to 100 hp at the Club.

This membership entitles the individual to have the option of berthing the vessel, to have the best rates on service and to vote on issues that affect the Club.

The spouse of a Senior Member shall have all the privileges of an Associate Member, and may exercise the Senior Member's vote in the absence of the Senior Member. Initiation fees and dues are waived.

Associate Membership

An Associate Member is entitled to all privileges of the Club except voting, holding office or maintaining a boat at the Club other than if the boat maintained is under 19 feet in length. The motor, if any, on such boat shall be 100 horsepower or less. The spouse of an Associate Member shall have all the privileges of an Associate Member with initiation fees and dues waived. Up to three (3) Associate Members may be elected to the Executive Committee.

Out-Port Membership

An Out-port Membership applies to an individual whose permanent residence is located outside the radius of 25 miles from the Club property. An Out-Port member is entitled to all the privileges of the Club except voting, holding office or using the boating facilities of the Club more than once (but not to exceed three consecutive weeks in any one calendar year).

RKYC MEMBERSHIP RATES

MEMBER CLASSIFICATION	AGE	RATE
SENIOR		
A	>60 + 25 YRS MEMBERSHIP	\$405.00
B	60+	\$690.00
C	35-59	\$815.00
D	30-34	\$615.00
E	25-29	\$410.00
F	19-24	\$205.00
ASSOCIATE	>60 + 25 YRS MEMBERSHIP	\$80.00
	25+	\$165.00
	19-24	\$80.00
	19-24 STUDENT	\$40.00
JUNIOR	14 - 18	\$40.00
OUTPORT	ALL AGES	\$125.00

ACCOUNTS RECEIVABLE POLICY

Overview

The RKYC is a non-profit organization that exists to promote sailing and provide cost effective services to members. The management of Accounts Receivable is an important and costly facet of the operations of the RKYC. Many members pay their accounts on a timely basis, but for those that do not the Executive of the Club and Staff invest significant time on collection. The Club incurs direct costs such as postage, paper, photocopying and bank financing charges that quickly erode the value of any finance income the Club may earn. To clarify the relationship between the members of the Club and those responsible for the management of the accounts receivable, the following policy has been developed for the benefit of all members.

Payment Methods

It is expected that current charges on members' accounts will be paid within thirty days. Management will in turn undertake to ensure accurate and timely billings to members.

To encourage timely payment, a 2.5 percent discount is offered if the account is paid in full by cash or cheque within 30 days.

In addition, payment may be made by Visa, or MasterCard, for members' convenience.

A monthly payment plan is offered. The total estimated charges for the current year (including membership fees, berthing, haul, launch and storage) are divided by the number of months remaining until February. An additional \$10.00 per month for boat owning members and \$4.00 per month for non-boat owning members will be added to cover administrative, financing and handling charges. The monthly payments can be made by Visa or post dated cheques.

In the event an account becomes overdue, interest is charged at a rate of 2 percent per month.

It is the objective of the Club to have all accounts either paid in full in 30 days or have members on a monthly payment plan.

New Members and Resignations

New non-boat owning members are required to pay membership dues in full (less any discounts offered) at the time their application is submitted.

Boat owning members are required to pay at least 50 percent of their membership dues on application and the remaining amount by a post dated cheque of Visa dated no more than 30 days later.

Members wishing to resign must submit written notice to the Club Office within 60 days of membership billings or the member will be required to pay the full amount.

CLUB HISTORY

The Royal Kennebecasis Yacht Club derives its origin from the Saint John Yacht Club, which was founded during two meetings of yachting enthusiasts in May 1884. *Frank Whelpley, Albert McArthur, Howard Holder* and *Fred Heans* believed that the sport of sailing could be better encouraged in Saint John through the organized structure of a formally established club. The Squadron on the new Club consisted of only six yachts. Initial dues were \$1.00 per year and \$1.00 for the entrance fee. During the first sailing season in 1884, the Club's anchorage was at Indiantown. Indiantown, however, did not provide sufficient room for expansion and after debate it was decided that the new anchorage would be located in Millidgeville. The first Clubhouse was constructed in 1895.

The Club membership decided at a general meeting on April 5, 1898 to adopt the name of the river on which its races were sailed. The organization was to be called the "Kennebecasis Yacht Club". The membership also consented to the application for the Royal Warrant which would permit the Club to use the prefix "Royal" in its name. Only three other yacht clubs in North America enjoyed this privilege in 1898. Notification that Queen Victoria had granted the Royal Warrant was received and the Club officially became the "Royal Kennebecasis Yacht Club" on July 5, 1898. It is interesting to note that because of a spelling error in the Royal Warrant "Kennebecasis" was spelled with two c's, and thus the spelling of the Club's name is slightly different from that of the river.

The R.K.Y.C. executive also applied for the Admiralty Warrant on behalf of its membership. This was granted on February 12, 1899. Each yacht of the R.K.Y.C. Squadron which was granted an Admiralty Warrant had the right to fly the Blue Ensign of Her Majesty's Fleet, often called the "Blue Duster". Possession of an Admiralty Warrant was considered a distinction for any yacht belonging to a Royal Yacht Club.

The second Clubhouse, which houses the present Club, was opened in August of 1901. It was built by contractor John Duffy at a cost of \$3000.00. In its day, it was an ambitious project. Today, this grand structure dominates the Millidgeville skyline. The Clubhouse tower stands 70 feet above ground level and has a commanding view of Brothers Cove. Its unique architecture serves as a focal point for the community. The Clubhouse is an integral part of the identity of the Royal Kennebecasis Yacht Club and its light is recognized as a beacon of hospitality by those who visit Saint John.

CALENDAR OF EVENTS

LAUNCH	Friday, May 12 & Saturday, May 13
MOTHERS' DAY BRUNCH	Sunday, May 14
MEMBERS' DAY	Friday, June 2
CORONATION CUP BALL	Saturday, June 3
CRUISE	Saturday, July 15 – Friday July 21
SAIL EAST REGATTA	Thursday, July 27-Sunday, July 30
HAULOUT	Friday, October 13 & Saturday, October 14
FINISH LINE PARTY	Saturday, October 21
FALL DINNER / CHRISTMAS RECEPTION	Saturday, November 25

FACILITIES

Clubhouse



We are convinced that we have the most beautiful clubhouse there is. Its windowed walls afford a fabulous view of our watery playgrounds -- the Kennebecasis River and Grand Bay -- and our balcony is THE place to see to view Monday and Wednesday night races and the most glorious sunsets you can find.

The Club has undergone extensive improvements over the past year. It is newly painted throughout and has new flooring in the entry. The existing hardwood flooring has been refinished, and there are new window coverings and . . . well, you'll just have to come and see all the improvements for yourself!

Once inside, you'll find washrooms with showers, a telephone for local calls, wireless internet access throughout the building, a bar (which is open during scheduled hours), the office, and a relaxing atmosphere in multi rooms on two levels with gorgeous views and lots of Club history paraphernalia. Climb the circular staircase right up to the top. See why members want to belong to the RKYC!

We are proud of this elegant facility and our house and grounds committee works very hard to keep the place in tip top shape for all the many functions that go on. Throughout the year (see our website for current listings).

Clubhouse Rental/Catering

The Clubhouse is available for rent. Senior and Associate members receive a 50 percent discount off the cost of the rental for personal or family events. Catering at the Club is provided by Duncan's Catering_only. Duncan's friendly and professional staff can work within your budget to ensure your event is a success. Weddings, birthdays and other celebrations can all be made special at the Club. The Club boasts beautiful scenic backdrops for photos will astound you.

Bar service for your event is usually available upon request.

For your next event contact the office for details (632-0186).

Parking

Ample parking is available in the yard and there is handicap access to the Clubhouse and the docks.

Please do not park on the main wharf or, most particularly, on the breakwater leading to A Dock. These areas, when accessible, are restricted for loading and unloading only with a respectable 15 minute parking limit.

During haulout, launch and on occasional special projects, parking within the property is not allowed. These times are posted on the website and are conveyed to members through email in a timely manner so as to cause as little inconvenience as possible.



**Royal Kennebecasis
Yacht Club**
Since 1898

Club Floor Plan

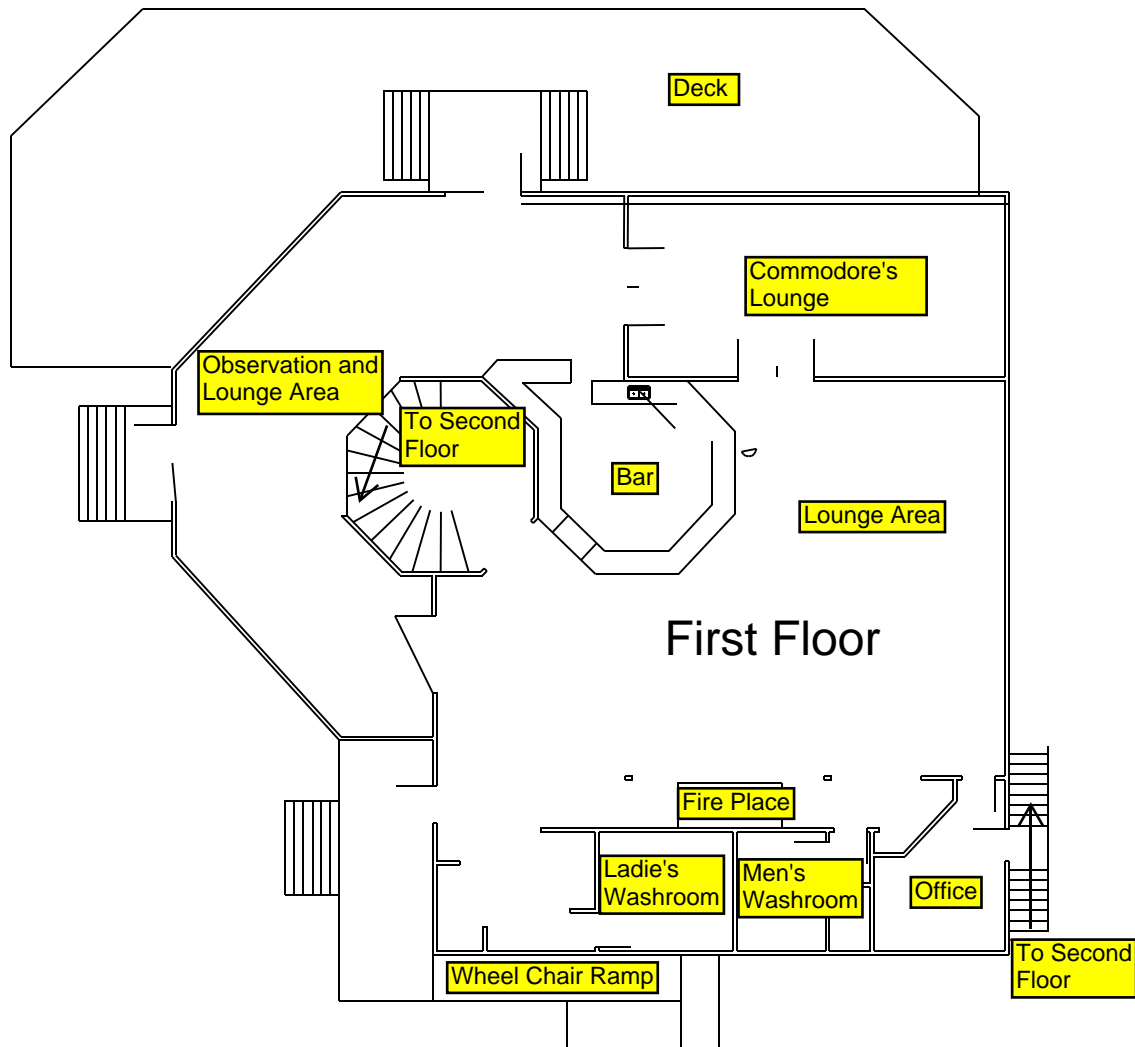
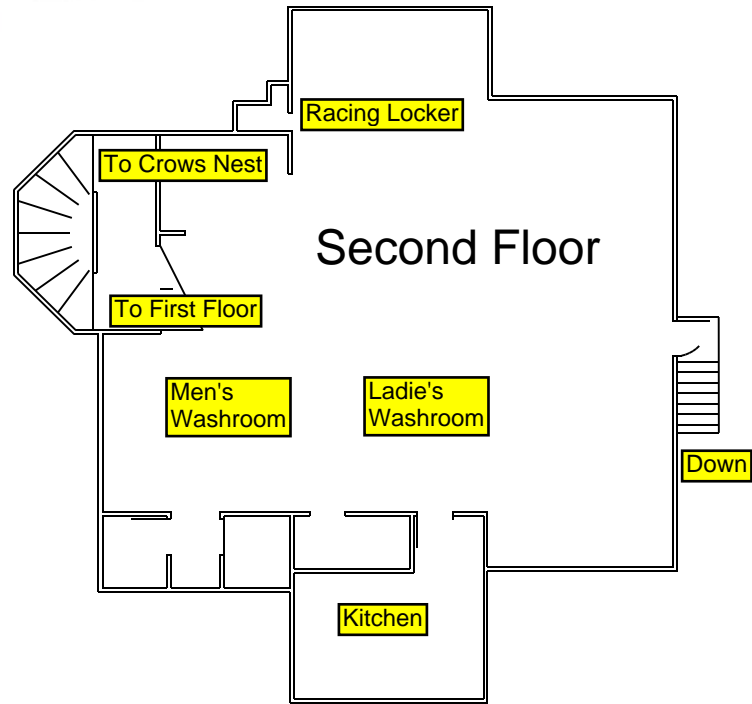

Parking

MARINE SERVICES

Marina

The RKYC Marina can accommodate up to 150 boats of varying sizes. A, B and C Docks are located in the cove surrounded by the breakwater. C is the closest to shore. A runs parallel to the breakwater and B runs straight down the middle of the two. Power and water are available on A, B and C docks.



FOR 2006!

NEW DOCKS await you in the marina. At 8 feet wide and 40 feet long, these docks will surely make tying up your boat quite comfortable. They also offer adequate room and stability for two people to pass if hoses, power cords, rope, garbage and coolers are left off the dock. It is therefore the responsibility of each boat-owning member to keep their area uncluttered. The docks will be cleared of improperly stored items if safety becomes an issue. No permanent fastenings of any kind are to be placed on the docks. Carpeting and hooks are to be removed from the pilings at the end of the season.

► Also, new to us this year (2006) is a larger crane capable of lifting most of the boats in our Club. This may be more convenient for some members and their schedules. See the yard manager for information.

Berth Assignment Policy

These guidelines have been established to provide framework for the fair and equitable assignments of berths in the marina in a consistent and safe manner.

In order to effectively manage the operation of the Club and the marina, the responsibility for the assignment of berths rests with the Club manager. The manager will consult with the Marine Services committee in order to maximize the usage of the marina in a safe and effective manner. Safety will always be the first priority when assigning berths.

For those applying for a new berth assignment, the following factors will be used to establish seniority.

1. Total years as a "boat owning"/"senior" member
2. Total years as a member of the Club (not consecutive years but total years as any class member)
3. How long they have been on the waiting list
4. When they applied for a berth

Boat Repair Services

Qualified craftspersons are available to carry out repairs on your boat. Contact the office for information (632-0186).

Spar Shed

The Spar Shed is used for mast and equipment storage in the winter and is used for repairs and tool storage during the summer. Tools are available to members for use but must be returned to their proper place at the end of the job or day, whichever comes first.

Garbage

Garbage bins are conveniently located by the spar shed and are for garbage created from boating, not from your household. Please recycle when possible.

Gas Dock

The Gas Dock is located on the main wharf, where our friendly attendants can assist you in acquiring gas or diesel, ice and water.

Please use great care when fuelling – avoid spillage of fuel into the water. No one other than the person responsible for fuelling can be on the boat during refueling. The gas dock attendant will not pump the fuel for you – no one knows your boat better than you. The pumping of fuel is the owner's responsibility.

Gas Dock Hours:

June 3 – June 25

0800 – 2000 hrs

June 26 – Sept 4 – August

Monday thru Friday 1100 – 2000 hrs

Saturday/ Sunday 0900 – 1800 hrs

Fall Hours (Sept 5- Oct. 7)

Saturday only 0900 – 1600 hrs

Fuelling Procedures

1. Tie boat to dock securely to prevent spillage.
2. Shut off all engines.
3. Send guests ashore.
4. Extinguish all open flames.
5. Do not smoke while refueling.
6. Turn off electrical switches and power supplies and avoid using electrical devices such as portable radios.
7. Close all windows, portholes, hatches and cabin doors.
8. Remove portable tanks from vessel before refueling.
9. Ground the nozzle against the filler pipe.
10. Know the capacity of the fuel tank and do not overfill it – you have a duty to prevent leakage or spillage of fuel into the hull or water.
11. Wipe up spillage and properly dispose of the cloth or towel used.
12. Operate the engine compartment blower for at least four minutes immediately before starting a gasoline engine.
13. Check for vapors from the engine compartment before starting up the engine.
14. Don't use your mobile phone.

Waste Fluids

Please properly dispose of used oil, antifreeze and other toxic substances. There is a disposal tank for waste oil by the spar shed. Under NO CIRCUMSTANCES should you dump hazardous wastes into the river or onto the ground.

Pump Out Station

The pump out station is conveniently situated on the main wharf. It is the responsibility of the boat owner to have a fitting for their pump out that adapts to our hose.

Haul Out & Launch

Launch in May, have fun on the water all summer, and haul out in October, count on it. It is the boat owner's responsibility to be available during haul out and launch dates and to notify the Yard Manager well in advance if you will not be launching or hauling. Extra fees will be assessed for late launch and/or haul out. From time to time as circumstances arise, your boat may need to be hauled during the boating season. The marina now has the capability to crane boats up to approximately 20 tons or haul larger vessels on the rail car. All repair work needs to be coordinated through the Yard Manager in order to ensure the needs of all members are met.

Storage

Storage for cradles and trailers is available on site. Contact the office for rates. It is the boat owner's responsibility to keep all cradles and trailers in good repair. The yard crew has the right to refuse moving or working with it if it is not.

There are storage lockers in the Spar Shed that are also available for rent. See the Club Manager for details.

RATES FOR SERVICES PROVIDED TO MEMBERS

SERVICE OFFERED	ASSOCIATE MEMBER <		
	SENIOR MEMBER	19' & < 100 HP	>19' OR >100 HP
<u>BERTHAGE</u>			
BERTH (SEASONAL)	B X \$53	B X \$53	N/A
BERTH (WEEKLY)	L X \$2.50	L X \$2.50	L X \$5.00
BERTH (DAILY)	L X \$0.50	L X \$0.50	L X \$1.00

<u>MOORINGS</u>			
MOORINGS (SEASONAL)	\$250.00	\$250.00	N/A
MOORINGS (WEEKLY)	\$50.00	\$50.00	\$100.00
MOORINGS (DAILY)	\$10	\$10	\$20

<u>HAUL/LAUNCH/STORAGE</u>			
HAUL/LAUNCH/STORAGE PACKAGE	L X B X \$1.54	L X B X \$1.54	L X B X \$3.08
FALL HAUL	L X B X \$0.46	L X B X \$0.46	L X B X \$0.92
SPRING LAUNCH	L X B X \$0.46	L X B X \$0.46	L X B X \$0.92
WINTER STORAGE	L X B X \$0.92	L X B X \$0.92	L X B X \$1.84
SUMMER STORAGE	L X B X \$0.92	L X B X \$0.92	L X B X \$1.84
HAULOUT AND LAUNCH ON RAIL (SUMMER) *	\$80.00 PER HOUR	\$80.00 PER HOUR	\$160.00 PER HOUR
HAULOUT OR LAUNCH BY CRANE (SUMMER)	L X B X \$0.46	L X B X \$0.46	L X B X \$0.92
HAULOUT AND LAUNCH BY CRANE (SUMMER)	\$125.00	\$125.00	\$250.00

<u>OTHER SERVICES</u>			
LOCKERS SINGLE	\$25.00	\$25.00	\$25.00
LOCKERS DOUBLE	\$50.00	\$50.00	\$50.00
MASTING BOOM USAGE	\$0.00	\$0.00	\$0.00
TRAILER SUMMER STORAGE	\$0.00	\$50.00	\$50.00
MAST INSTALLATION/REMOVAL	\$65.00	\$65.00	\$80.00
STRAP/SPREADER BAR USAGE	\$25.00	\$25.00	\$50.00
BOATS MOVED IN YARD (HYDRAULIC TRAILER)	\$50.00	\$50.00	\$100.00
BOATS MOVED IN YARD (OWN TRAILER)	\$25.00	\$25.00	\$50.00
LABOUR RATE	\$40.00 PER HR	\$40.00 PER HR	\$80.00 PER HR
CRANING RATE, MINIMUM 1/2 HOUR	\$80.00 PER HR	\$80.00 PER HR	\$160.00 PER HR

HST EXTRA

B = BEAM, L = LENGTH OVER ALL

* RAILCAR HAUL-OUT PROVIDES THREE DAYS USE OF THE RAILCAR, AFTER THAT A CHARGE OF \$35.00 PER DAY APPLIES

MEMBER SERVICES

The RKYC has a century long history of being a gateway to the beautiful Kennebecasis River, allowing members of the Club to enjoy a scenic and unique safe harbour.

There are numerous services available for members. The Clubhouse is available for dining, rental, refreshments or enjoying a summer sunset. A large marina offers new docks (2006) which create more space and allow for stable and safe access to boats. The boatyard staff and volunteers provide a wide array of services for boaters and are often available to help with repairs and advice. The office staff is always available to assist members with inquiries and to help with solutions.

There are also special events available to members - dinners and dances, wine tasting events, safe boating presentations, sailing regattas and the annual summer cruise, to mention a few.

Whether you are a competitive sailor, a power boater, a day sailor or a serious cruising boater you will find the rich history, wonderful waterways, superb marina and friendly, knowledgeable people just some of the reasons to become a long standing member of the RKYC.

Club Events

Various Club events occur at all times of the year. You are encouraged to attend as many as you can. Watch for mail outs and visit the website (www.rkyc.nb.ca) often for details on upcoming events.

Members' Day

An annual event that jump-starts the sailing and cruising season, Members' Day is typically held on a Friday evening early in June, beginning at around 1800 hrs. A reception is held in the Clubhouse where a casual light meal is enjoyed while listening to a few remarks made by the Commodore. Our Fleet Chaplain blesses the fleet and often we hear of cruise details from the Fleet Captain. Soon after, a short ceremonial firing of the cannon takes place, then it is out on the boats for the formal sail past at 1930 hrs. All members (Senior, Associate and Out-Port) are welcome. If you do not own a boat, identify yourself to the Commodore and arrangements can be made to get you out on the water. Watch the Blue Duster and the Website for more details.

Buffets

The RKYC's official caterer, Duncan's, provides a beautiful dinner buffet in the Clubhouse every Thursday evening. The main course (beef to turkey, chicken and pork) changes each week. The buffet also includes steamed PEI mussels, a selection of freshly made salads and cold buffet items, potatoes or rice pilaf, a medley of seasonal vegetables, fresh rolls & butter, and the chef's selection of delectable desserts, coffee and tea.

The buffet is available from 6:00 to 8:00 pm. Cost is: roast beef dinners - \$22 per person; all other dinners - \$15.00 per person, unless otherwise stated

Come along and bring a friend! This is a popular Club event, so please call one day in advance to reserve your spot.

Office Phone: 632-0186; email: rkyc1@nbnet.nb.ca

Volunteers

As with every non profit organization, volunteers are always needed. Volunteering at the Club can be fun and very rewarding. Help out in a general way by attending some of the collective member events (ie: launch and haul out, general yard clean up after spring launch, installing water and electrical lines on the docks, removing same after haul out, race buoy painting and placement) or offer your expertise on one or more of the Committees. Come out and get involved, You won't regret it!

BOATING ETIQUETTE

Sail Past Protocol

The Sail Past takes place in the area inside of the Brother's Islands. Sailboats are to be sailed under main and jib alone. Auxiliary power may be used, when available, to maintain position and safety. In the event of calm winds, smaller boats and dinghies may be towed.

The Reviewing Point is on the starboard side of the yacht. A boat (TBA) will be moored in the harbour in front of the main wharf. The dispersal point for all boats participating in the Sail Past will be a reasonable distance beyond the Reviewing Point as determined by wind conditions.

Yachts are to proceed to the designated marshalling area and take station under the direction of the Fleet Captain. The Commodore will lead the fleet, followed by the Flag Officers and the Past Commodores followed by Junior Sailing. The rest of the fleet should generally have the large sailboats leading, power boats to tail. The Fleet Captain should be last. Departure from the marshalling area will be the western or eastern passage, as determined by wind directions.

Yachts should be sailed from the marshalling area to the Reviewing Point, line-a-stern, at 30-yard intervals. On approaching the Reviewing Point, yachts salute from two boat lengths before the Reviewing Point to two boat lengths after.

For the Review itself, lead yachts are to maintain a speed that allows following boats to keep in station. In favourable winds, sails should be set up so as not to exceed four knots of speed.

An appropriate Salute consists of "dipping" the ensign, with the Skipper and crew facing starboard with head gear doffed. Boats without ensigns will salute by luffing the jib. The salute will be taken by the Honorary Commodore in company with a number of Past Commodores of the Club.

Boat dress for the occasion is appropriate sized ensign and burgee. The first boat will cross the Reviewing line at 1930 hours.

The guard frequency for the Sail Past is channel 68 VHF. Those with VHF sets will relay information to those without. In the event of an emergency, a warning will be broadcast to all vessels. For safety, the accepted rules of the road are to be observed.

No Wake Zone

Please respect the environment, other boats and your marina by driving your boat slowly upon approaches to the mooring field, along the front of the main wharf and in the marina.



FLAG ETIQUETTE

The Club burgee may be displayed only when a yacht is under the direct command of a Club member. The Club burgee shall be displayed at the bow staff of single-masted power yachts, at the foremost truck of schooners and multi-masted power yachts and at the mainmast truck of other rigs. See the office for purchase of the Club burgee.

Flag officers, post captains and fleet captain flags shall be displayed day and night at the mizzen truck of yawls, ketches and similarly-rigged power yachts and at the main truck of cutters, sloops, schooners and single-masted power yachts. When a flag officer uses a member's yacht for official business, his flag shall replace the Club burgee.

Nautical Flag Alphabet

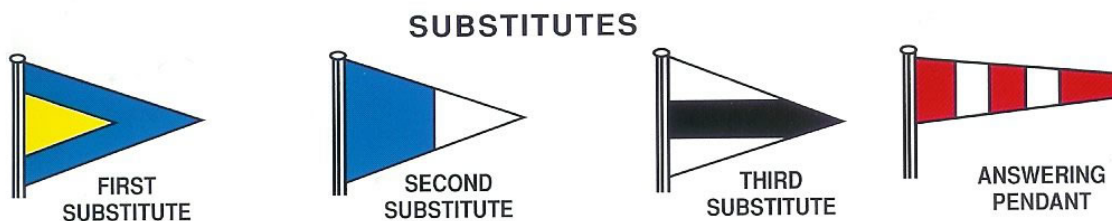
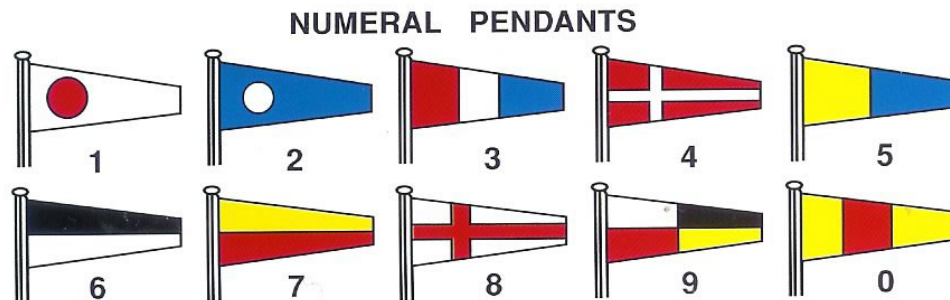

SAILING AND RACING

Annual Cruise

The Annual Cruise is the highlight of every summer boating season and is an excellent opportunity to get to know other members. You can participate in as much or in as little as you wish for as many days as you want. It is a fun event for the kids and it has been said that even adults like it too. Stay tuned to the website for dates and itinerary.

Racing

The RKYC is an active racing club with a full slate of events from May to October.

Monday Night racing is cruising class, white sail only (no spinnakers). This is a good night for new racers to get to “know the ropes.” Oftentimes the more experienced racers in the Club are available in the Clubhouse after the races to discuss strategy and technique.

Tuesday nights Junior Sailing members take to the racing waters, where they practice the skills learned throughout their courses. It is quite something to watch the competition between single handed bytes and lasers and those with crew.

If you wish to race more competitively, come on out on Wednesday nights. A social is usually held in the Clubhouse after the race. Refreshments are hosted by a different boat's crew each week and the evening features a video of the night's race. It's a great time for everyone.

Many weekend races are also held and at the end of the season a party is held to celebrate the memories with food, drink, trophies and lots of other prizes. Keep an eye on the website for start times and other pertinent information.

Popular Places to Visit on the Rivers

There are many beautiful spots on the Kennebecasis and St. John Rivers to spend a day, an evening, a weekend or longer. Here are some of our members' favourite anchorages:

Keith's Cove (behind Kennebecasis Island)

Whelpley's Cove

Jenkins Cove

Colwell's Creek

Big Cove

Grand Lake – Douglas Harbour, Grand Bar

Kingston Creek

River Hazards

In the vicinity:

Red Rock, Man of War. (Ask a member)

EDUCATIONAL PROGRAMS

Learn to Sail

The RKYC offers Learn to Sail programs for all ages and skill levels. Well trained instructors will teach you to sail in many different sizes of boats.

RKYC Junior Sailing Program

The goal of the Junior Learn to Sail Program is to teach safe and proper handling of a small sailboat while developing enthusiasm and a love of the sport. The course is taught according to the Canadian Yachting Association. Its standards emphasize safety, theory, boat handling and sportsmanship. The program is taught by CYA-qualified instructors who are in attendance at all times, both on land and on the water in rescue boats.

Competitive sailing is available outside the course times. Competitive sailing usually involves attending local, national and international events and is offered as a separate program.

The prime objective of the Learn to Sail Program is safety and skill development for personal enjoyment and fellowship.

Behaviour Policy

The RKYC undertakes to ensure an enjoyable experience for all that attend the course(s). Accordingly, actions that are deemed to be inappropriate behavior will not be tolerated. These include, but not limited too, bullying, physical aggression, verbal abuse to other children, disrespect for instructors, damage to Club equipment/premises or another child's possessions and deliberate misconduct on the water.

Depending on the nature of the incident of unacceptable behavior the parent will be contacted and appropriate action will be taken (this may consist of dismissal from the course).

Canadian Power and Sail Squadron

The Kennebecasis Power and Sail Squadron provides courses in boating safety for recreational boaters in southern New Brunswick. The CPSS is a volunteer, not-for-profit organization dedicated to promoting safe boating through education. Their courses are designed for boaters with a wide range of interests, from cottage boaters to blue water cruisers.

Check out their website at: <http://kennebecasis.cps.org>

WHY CHOOSE THE RKYC?

Centre of Yachting Excellence
The Maritimes' most extensive racing program
Protected marina, safe harbour and storage location
Berthing, moorings, haul, storage, launch, gas, diesel and pump out
Food and Bar facilities
Excellent meeting and reception location
Flexible payment and billing plan, including discounts for early payment
Payments by VISA and MasterCard accepted
Special members' prices for services
Welcoming atmosphere with a year round social calendar
Breath taking views
The gateway to hundreds of miles of waterways to explore

WHAT DO YOU DO NOW?

- Provide us with your email address, so that you will be included in updates and news
- Attend Club functions and volunteer, so that you can meet other members and their families
- Most of all enjoy the benefits of being a Royal Kennebecasis Yacht Club member!